



2020 NEW *PRODUCT*

**Brake components
OEM/ODM made in Taiwan**





CONTENTS

04

LAB.
INTRODUCTION

06

BRAKE SHOES

07

DISC PADS

08

ROTORS

10

ADAPTERS

12

PARTS

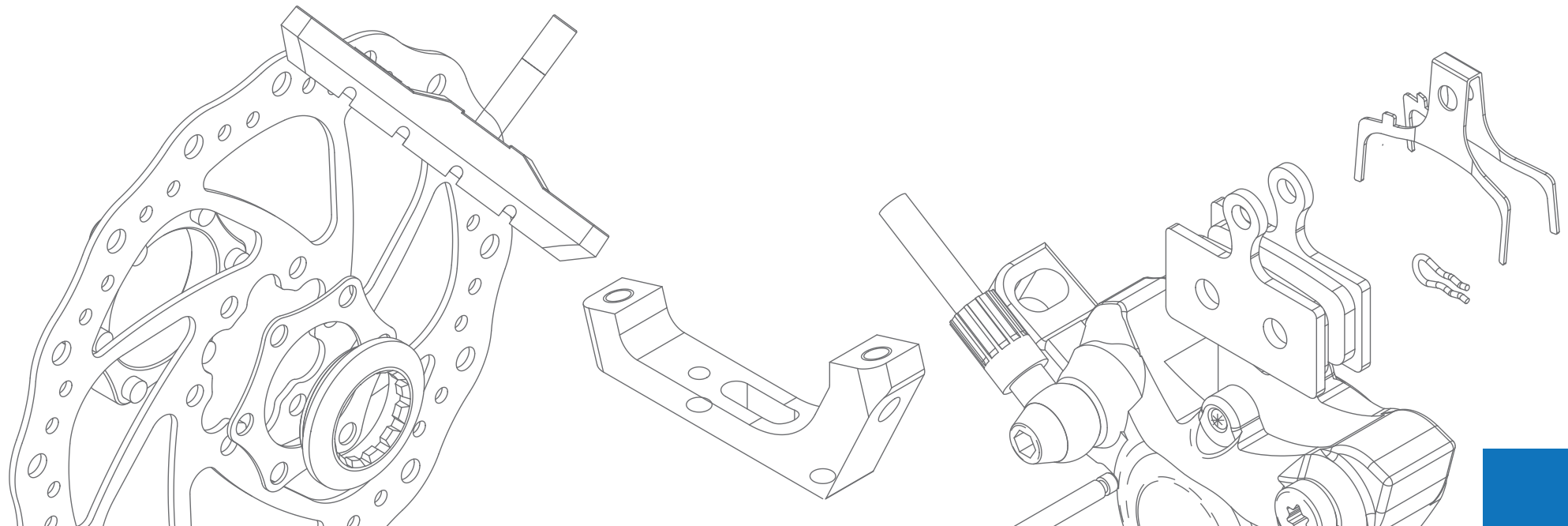

LABORATORY INTRODUCTION

Max. 110 KM/HR

Temperature monitored per 0.5 seconds

Max. 700 degrees Celsius measured

Infrared camera with high performance infrared thermometer:
Allowing for the detection of 16 spots on the rim surface.

4 cc water spray per second

10000 stops

2.2 m/s² deceleration

Natural rubber
Synthetical rubber
Kevlar®
Ceramic
Mixed power

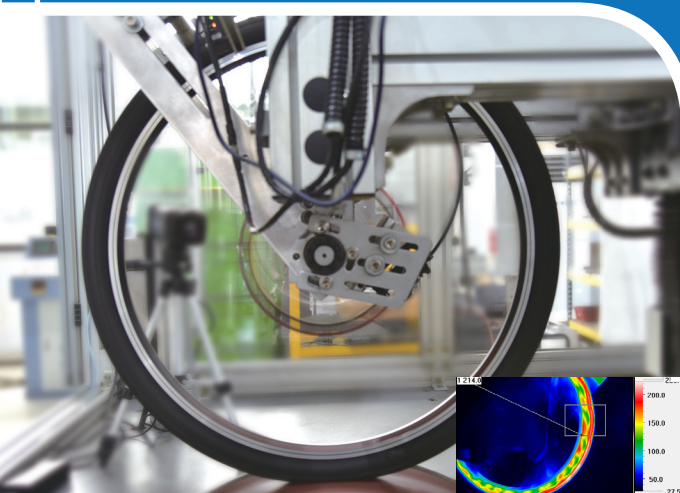

BRAKE SHOES



R-502

- White painting color prevents rubber from sun directly
- Good braking performance on all weather condition
- Increases 30% more power



DISC PADS

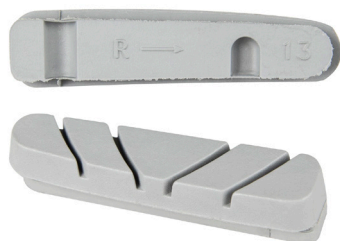

R-716

- Bigger brake surface and 4 slots
- More stopping power
- Removes dust and water efficiently



BP-68&SP-68

- FORMULA CULA 4
- Sintered compound available



BP-69&SP-69

- HAYES DOMINION A4
- Sintered compound available



ROTORS

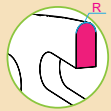

Rounded edge band

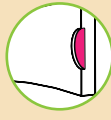

Wear-out indicator



Center lock type



FRC-01SS

- Pressed steel carrier

SIZE OPTION	GRAMS
140mm	139g
160mm	155g
180mm	175g
203mm	212g



FRC-01SA

- Precisely CNC machined 7075 alloy carrier

SIZE OPTION	GRAMS
140mm	123g
160mm	149g
180mm	176g
203mm	214g



FR-16SA

- 7075 Alloy carrier
- Rounded edge braking band
- Color option: R G B GB BK

SIZE OPTION	GRAMS
140mm	104g
160mm	118g
180mm	142g
203mm	188g

FR-11SA Huge rotor 220mm

TEMPERATURE COMPARISON CHART

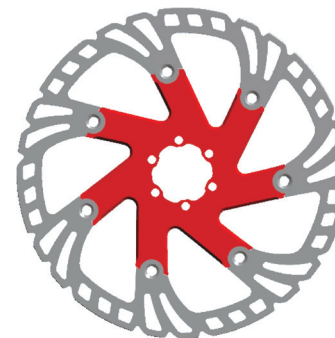
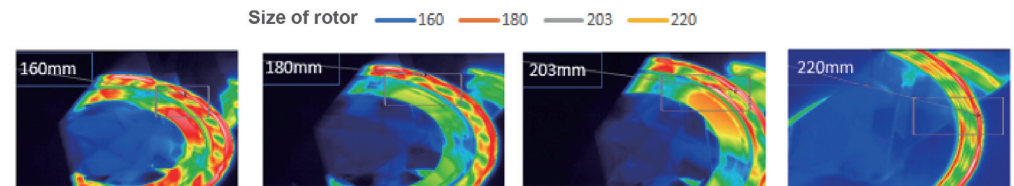
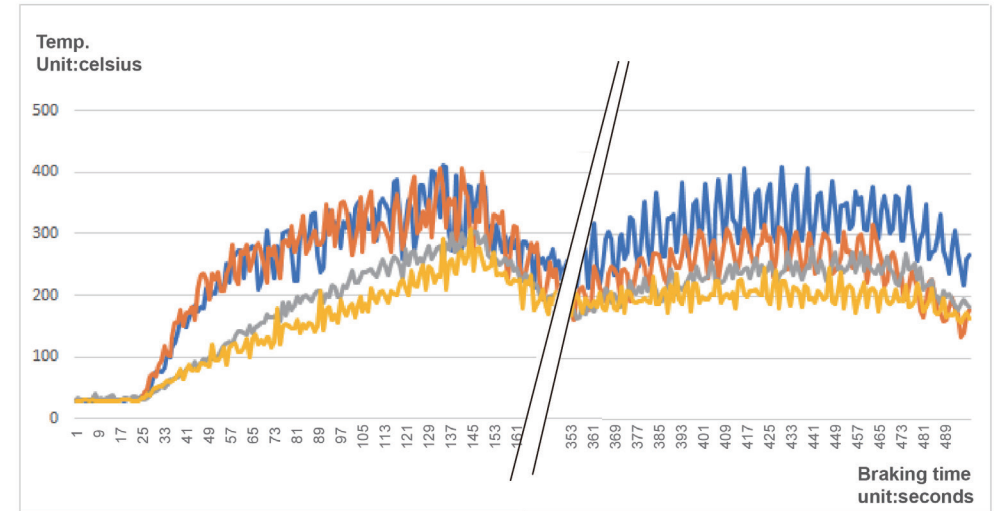





- Spiders more stronger
- Less heat generated under the same braking power
- Shorter braking distance under same lever load
- 2mm thickness

SIZE OPTION	GRAMS
220mm	225g

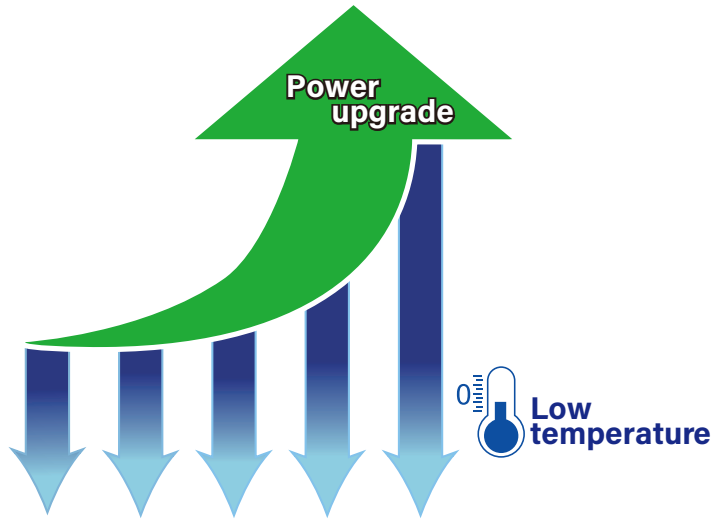
ADAPTERS

- Flat mount system for **180mm** rotor
- To solve overheating problem for heavier riders



FORK AND FRAME	CALIPER AND ROTOR	POST MOUNT CALIPER	FLATMOUNT CALIPER
	180mm rotor		
FLATMOUNT FORK			
	AP-25	AP-24	
FLATMOUNT FRAME			
	AP-21	AP-22	

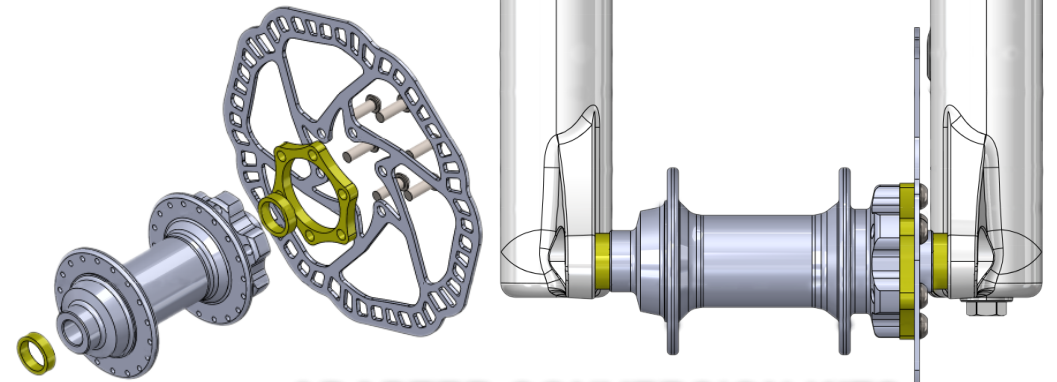

ADAPTER CONVERSION KITS FOR BOOTS HUB



CL-06

- Fits boost fork at specification of 15 x 110mm
- 5mm thickness



CL-07

- Fits boost frame at specification of 12 x 148mm
- 3mm thickness

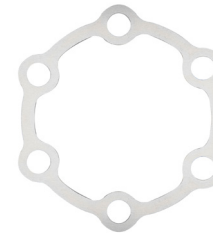

CL-WS-05

- 0.2mm thickness
- Aligning the rotor within the caliper



AP-27

- Postmount caliper for **220mm** rotor



BRAKCO INDUSTRY CO., LTD.

No.577, SEC. 1, FANHUA RD., FUSING TOWNSHIP,
CHANGHUA COUNTY 506, TAIWAN
TEL: 886-4-7794916 FAX: 886-4-7794917
E-MAIL: brakco@brakco.com.tw